



RIVIERA



AUSTRALIA'S MOST AWARDED LUXURY BOAT BUILDER



5000 SPORT YACHT WITH ZEUS | THE ULTIMATE RIVIERA

## PUTTING MORE LIFE INTO YOUR LIFESTYLE

The inspiration for our Sport Yacht series, came from recognising the changing values and lifestyles not just of boat owners, but people everywhere – changes that are reflected in such domains as contemporary architecture, interior design and the styling of prestige cars.

Although luxury is more desirable than ever, the trend globally is towards less formality. In so many areas of life, easy living and convenience have taken the place of stuffy traditions, unnecessary embellishments and sometimes ostentatious and impractical features.



1



2



3

1. Wide side decks with generous height handrails make docking and moving forward safe and easy. 2. The expansive cockpit features an aft lounge that runs the full width of the transom. 3. The large foredeck features a large double sun pad with adjustable back rests, integrated pillows and glass holders.



Such was the thinking behind the design of our 5000 Sport Yacht. The clean lines, the bright, contemporary interior, the modern materials, the emphasis on easy entertaining, the solid feel and handling together with the spirited performance are among the many qualities that have made this one of our most successful models ever.

The flow between the cockpit and the saloon that so many find refreshing is inspiring on this 50' model. It brings the inside outside like never before – and the saloon is brighter and lighter than ever. The ease with which you can cater to a large party and the standard of comfort your guests can enjoy is magnificent.

Australians are masters of informal entertaining. For us it is all very relaxed, even though our catering is often lavish and of superb quality – so it is only fitting that it should be a vessel with an Australian heritage that brings these principles to life on the water.



4



5



6

4. The garage can accommodate a tender up to 3.1m in length. 5. Even at anchor, the 5000 Sport Yacht has a sense of sweeping speed about her sheer line. 6. Optional seating and table can be incorporated into the forward port side of the cockpit under the weather protection of the cabin roof overhang and sun awning.



## ENGINEERED FOR YOUR PLEASURE

The 5000 Sport Yacht is above else a robust, reliable and brilliantly engineered vessel. It is a boat in which you can have supreme confidence.

The innovative propulsion system offers easy manoeuvring in close quarters such as marinas as well as overall performance. Cummins Diesel claims up to 30 percent improved fuel economy as well as 15 percent faster cruise and top speeds over conventional drive units.

The underwater profile of the Riviera 5000 Sport Yacht includes two Zeus drive units with aft-facing counter-rotating propellers with underwater exhausts. The drives are mounted in tunnels that protect the pod drives from underwater debris.

An advanced joystick control system for slow-speed manoeuvring can be operated with one hand and a single turn of the wrist; from sideways tracking to spinning on a pin, to precise speed control. Zeus also features Skyhook™, a system that will maintain the vessel on a fixed heading within a tight area – even in strong currents and windy conditions.

This stability is enhanced by having a large-capacity, mid-mounted fuel tank for extended range. This Sport Yacht is made for serious voyages as well as playful day cruising.

The relentless pursuit of perfecting our craft is evident in so many details – for instance, small fibreglass components like hatches and the swim platform are made with an injection moulding process to create a stronger component with a better double-sided finish.

Our Sport Yachts reflect the solid character and stable ride of our world-famous and award winning Flybridge boats. The 5000 Sport Yacht is as agile and exhilarating as it is sure and steady. It is a boat designed to give you the best of both worlds.

7 and 8. The near perfect boat design that ticks all the 'must have' boxes on your boating wish list. Exhilarating performance with pod drive economy and ease of handling. Large cockpit with good weather protection and integrated furniture on the same level as the saloon. An aft galley adjacent to the cockpit for relaxed entertaining. Wide walk around side decks, sun pad, large electric sunroof (standard) and tender garage with huge lowering swim platform capable of taking a PWC. You couldn't wish for more.











10



11



12

## YOUR OPENING TO MORE ENJOYABLE ENTERTAINING

Open the saloon door, open up the large, polished, stainless steel-framed rear window and you have transformed the cockpit and saloon into one enormous area, ideal for relaxing, socialising and entertaining. It's all on one level too. Just to enhance the sense of light and space – and create a pleasant through breeze – the side windows in the saloon slide open and there is a huge, electrically operated sunroof above the helm station.

Locating the galley aft by the rear door not only allows you to cater to the saloon and cockpit with ease, but the chef is always involved with the party. It's a very substantial galley too, with everything from high-quality vinyl flooring in the saloon to a large pantry, convection microwave oven, ample storage space and an optional drawer dishwasher. The cabinetry is clean and modern in its design. This is accented by the solid surface benchtops and stainless steel sink.

The cockpit offers generous seating, a large table that converts to a sun lounge via electric table legs, an electric barbecue and a teak-laid swim platform that raises and lowers at the touch of a button – a feature that comes in particularly handy for launching the 3.1 metre tender that is neatly garaged out of sight and out of the elements.

For serious sunning, large cockpit steps, wide side decks and a hand rail lead to a delightful sun pad on the foredeck. If you are more inclined to escape the midday sun, the luxurious leather lounge in the reverse cycle air-conditioned saloon will be a welcome escape. Plug your iPod into the high quality sound system or watch a movie on the LCD TV – that also disappears on an electric lift when not in use.

One of the greatest pleasures must surely be sitting at the helm. The helm chair is electrically adjustable and, like the companion chair, clad in the finest leather; the console is ergonomically designed and the vast, curved windscreen presents you with sensational views... It all adds up to a delightful sense of confidence and control.

9. The lounge/dining area runs the full length of the port side of the saloon and features an adjustable and folding table. 10. The ergonomic helm station features fully adjustable dual helm chairs. 11. The very equipped galley features a convection microwave, two burner hot plates, two drawer fridges and freezer, large sink and (optional) drawer dishwasher. 12. The dining table fully extended.

## ACCOMMODATING YOUR PERSONAL PREFERENCES

We know how important it is that your boat reflects your tastes, so when it comes to furnishings and fabrics we offer a wide choice of colours and styles. Below deck we go even further with customising your boat by giving you the choice of three staterooms and two bathrooms or two staterooms, two bathrooms, plus a second, more intimate lounge.

With the first option you have comfortable accommodation for seven. The alternate configuration provides you with another entertainment area below, perfect if you have children or grandchildren. Alternatively, it provides a welcome parents' retreat.

The Master Stateroom is spacious and bright and features a walk-around queen-size bed with innerspring mattress. Under-bed storage (easily accessible by virtue of gas struts), overhead cabinets and other storage and cedar lined hanging lockers accommodate everything you need for extended voyages.

Aft is the full beam VIP guest cabin that is also extremely comfortable and well laid-out with a double and single bed – and little touches like the cedar lining in the hanging lockers tell of the attention to detail that has gone into this design.

To starboard a further guest cabin features two pullman berths.

The 5000 Sport Yacht benefits from our advanced robotic varnishing facility. The gloss timberwork found both above and below deck has an utterly smooth, mirror-like finish.

Our commitment to quality design, materials and workmanship is also evident in the ensuite and second bathroom. Here you'll find Amtico flooring, solid-surface bench tops, elegant glass-bowl basins, the best mixer taps and showerheads and frameless doors to the shower stalls.

13 and 16. The full beam aft cabin features a double bed to starboard, a single berth to port, opening port holes and generous port lights in the hull.

14. The starboard guest cabin features two single pullman berths, an opening porthole and ample storage.

15. Master stateroom ensuite.

17. Guest cabin bathroom 18. The Master stateroom offers a pleasing palette of fine timbers, fabrics and finishes. Large portholes in the hull make this a very inviting space.

19 and 20. In the two cabin option layout, the lower lounge that replaces the third cabin is designed with a plush lounge that can convert to two single beds.



13



14



15



16



17



18



19



20





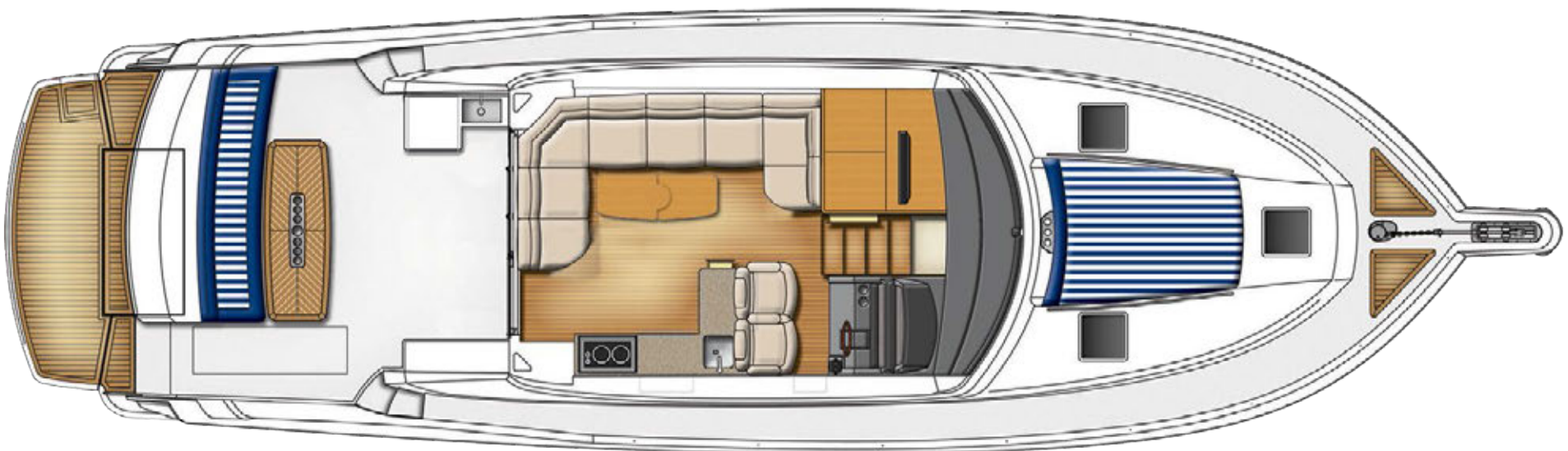
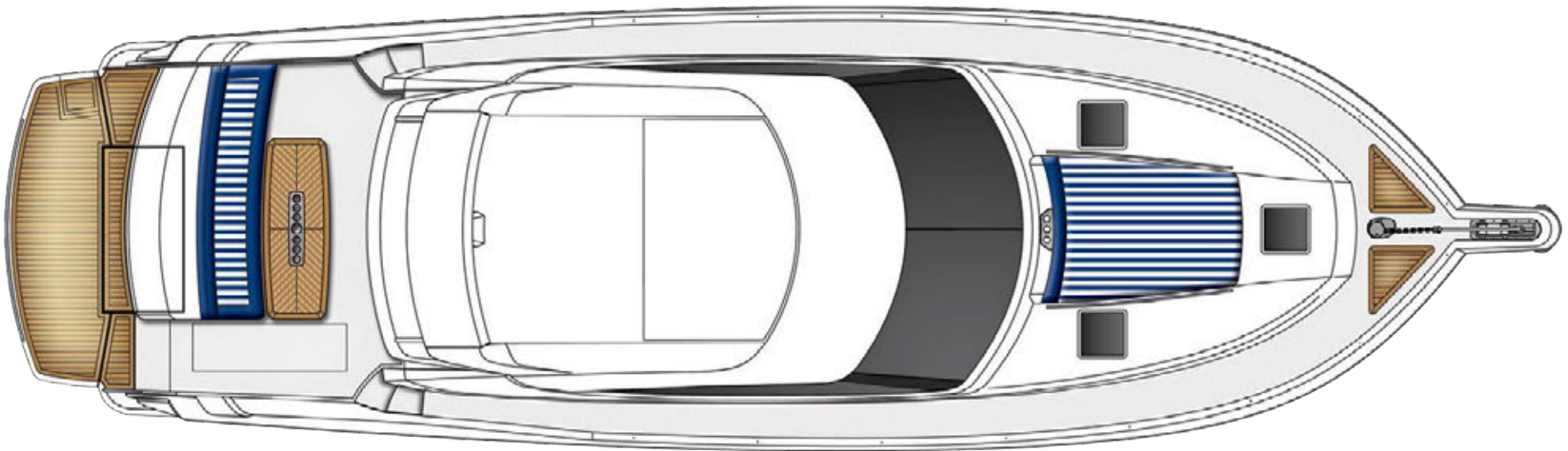

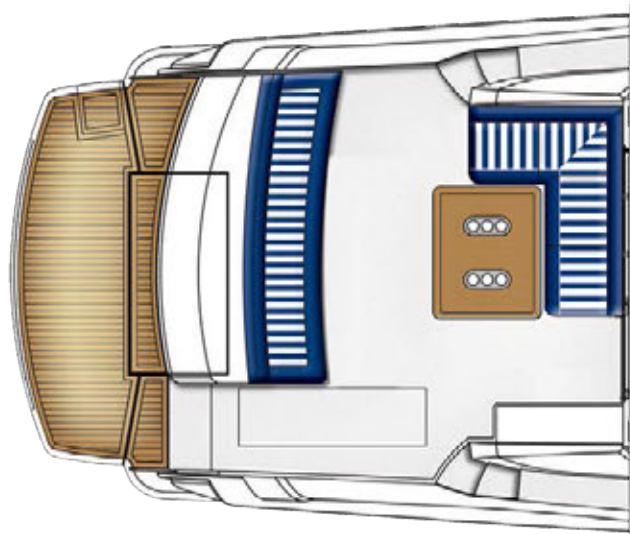
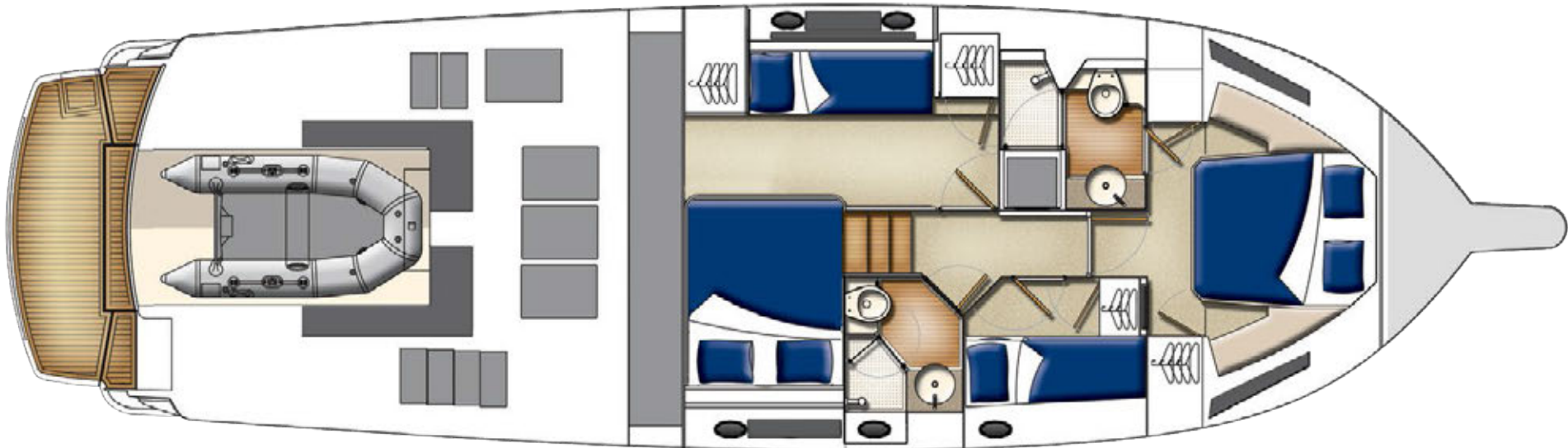

Optional Cockpit Layout

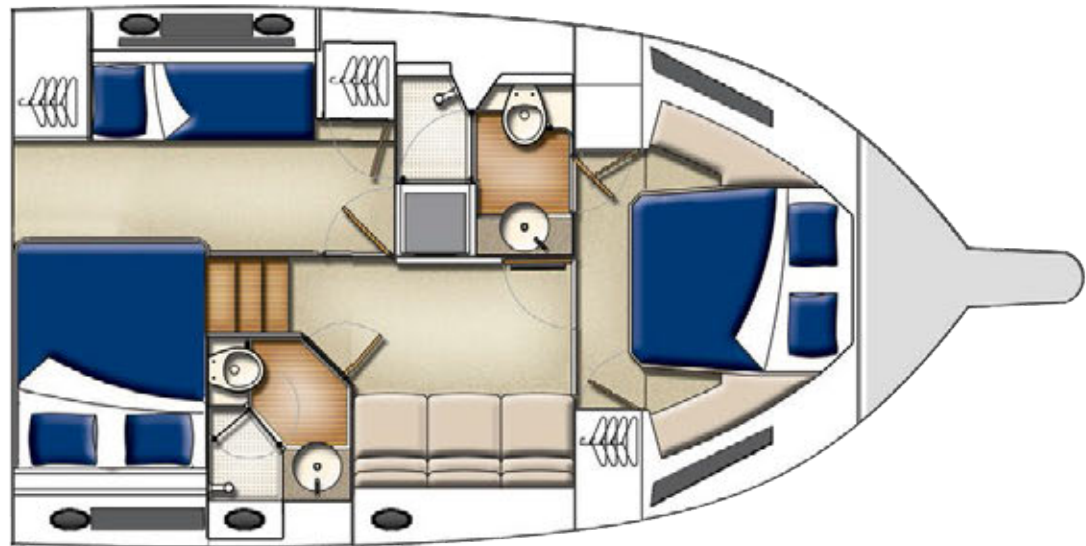

Optional 2 Cabin Layout



## CRAFTED WITH PASSION

Riviera is an Australian success story and a major international marketer of luxury pleasure boats. Our growth over more than 34 years has resulted in a company that today creates and manufactures three individual model collections and supports an international dealer network that spans more than 60 countries. We are also Australia's most awarded pleasure boat manufacturer.

The secret of our success is an absolute commitment to quality. Be it our 400 strong team of people, our work practices, materials, tools and technology, environmental responsibility or after sales service, we are rigorous in pursuing the highest standards.

Our craftspeople consult world-leading naval architects, engineers and designers. Our employment and training practices have also earned us many local and national awards.

Riviera operate the largest luxury boat building facility in the Southern Hemisphere and boasts some of the most sophisticated technology available.

## AWARDED FOR EXCELLENCE

Riviera's vast collection of industry awards is a reflection of the pride and passion our master craftsmen put into every model in our premium range of Australian-built luxury pleasure craft.





The home of Riviera. The 14 hectare state-of-the-art manufacturing facility on the Gold Coast in Queensland. This is the largest facility of its kind in the Southern hemisphere.

## RIVIERA'S ETHOS INSPIRES CONFIDENCE

The quality of our service is commensurate with the quality of our boats and is something we are passionate about. The experience of purchasing your Riviera, from the selection of the electronics and décor, to the regular service and maintenance will all be carried out reliably, promptly and smoothly. In fact, you can count on us, and our global dealer network, for the life of your boat.

It is this consistent quality that has created Riviera's enormous and ever-growing international appeal.

Today there are over 5000 Riviera luxury boats located in all corners of the globe.

A sensational and growing choice of models, an impeccable pedigree, excellent value and outstanding service: now more than ever, Riviera's reputation for quality with integrity inspires confidence in boating enthusiasts the world over.

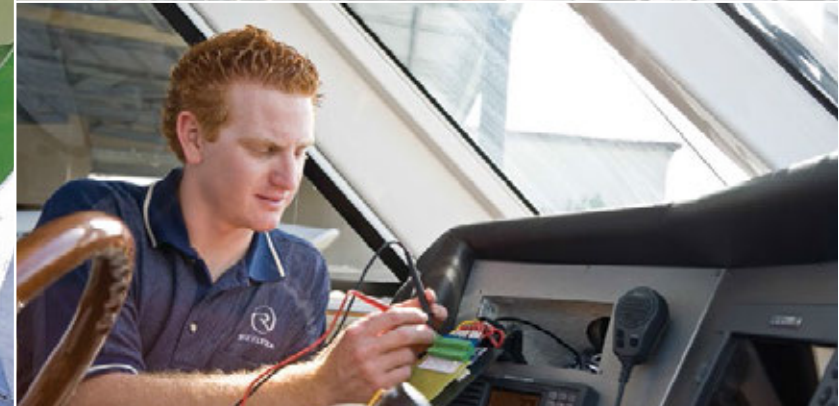
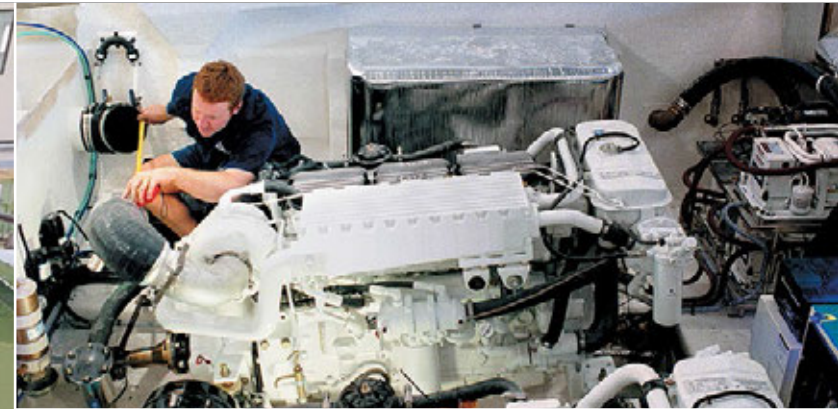



The growing Riviera global network of dealers now spans 60 countries. Find a dealer near you at [RivieraAustralia.com](http://RivieraAustralia.com)





## ELECTRONICS

Electronics play an ever-increasing role in the pleasure, performance and safety of luxury boats, and the choice of equipment that is available today is vast. In fact, selecting the equipment that meets your needs can be a very challenging task. R Electronics is here to help: we source the best systems and products from around the world, we are experts at matching technology to individual requirements and work closely with Riviera's design team and Riviera's global Dealer Network to create systems that maximise your pleasure and safety.

[RElectronics.com.au](http://RElectronics.com.au)



## STYLE

A passion for quality and good design steers everything we do at Riviera – and that is reflected in our exclusive range of clothing, accessories and decor items. If you love your Riviera, you'll feel at home with the Riviera Collection: casual yet stylish, comfortable, practical and made to withstand the rigours of boating life.

The Accessory and Decor Collection ranges from a storm jacket to stylish crockery. Riviera has the total leisure and style solution.

[RStyle.com.au](http://RStyle.com.au)



## INTERIORS

To make your boat truly your own, we offer a wide choice of fabrics, finishes and color schemes that allow you to customise your Riviera. Of course, we also have experienced designers who can advise and assist with your individual selection.

It is a real pleasure to own and use things that are aesthetically pleasing, work well and last – and because it is only appropriate that such qualities are found on board a Riviera, we supervise each individual interior scheme from creation to installation.

[RInteriors.com.au](http://RInteriors.com.au)





## THE RIVIERA EXPERIENCE

When you buy a Riviera, you are really joining a family.

Indeed, this "Riviera Experience" is something we take very seriously and value very highly – we believe our core duty is to help owners of our world-class, Australian-built luxury pleasure craft to achieve the ultimate boating experience.

So you can imagine how proud we are that this commitment is something highly valued by members of our Riviera "family" of owners too.

With exclusive invitations to special adventures, social events and educational workshops, the "Riviera Experience" runs much deeper than owning a striking, sophisticated and stylish boat which not only looks a cut above the rest but also delivers in terms of superior sea-handling and innovative on-board technology.

Perhaps our passion is best reflected in the words of our Riviera owners:

*"I had not even turned the key on my new 445 and I already felt part of the Riviera family. I've owned a number of boats and maybe I'm a slow learner ... I should have bought a Riviera earlier!"*

*"We really enjoy coming together as the Riviera community. We've been on a couple of the Experience trips and there's a real safety aspect of going offshore and being around other Riviera owners, who know their boats and your boat too."*

And one more ...

*"Riviera goes over and above all expectations to make sure owners enjoy a great experience for the entire life of their boats. That lifelong commitment is something that really makes a difference."*

Yes, they are glowing endorsements and they are all from long-time Riviera owners who share something truly unique – they share the truly unrivalled "Riviera Experience".



RIVIERA

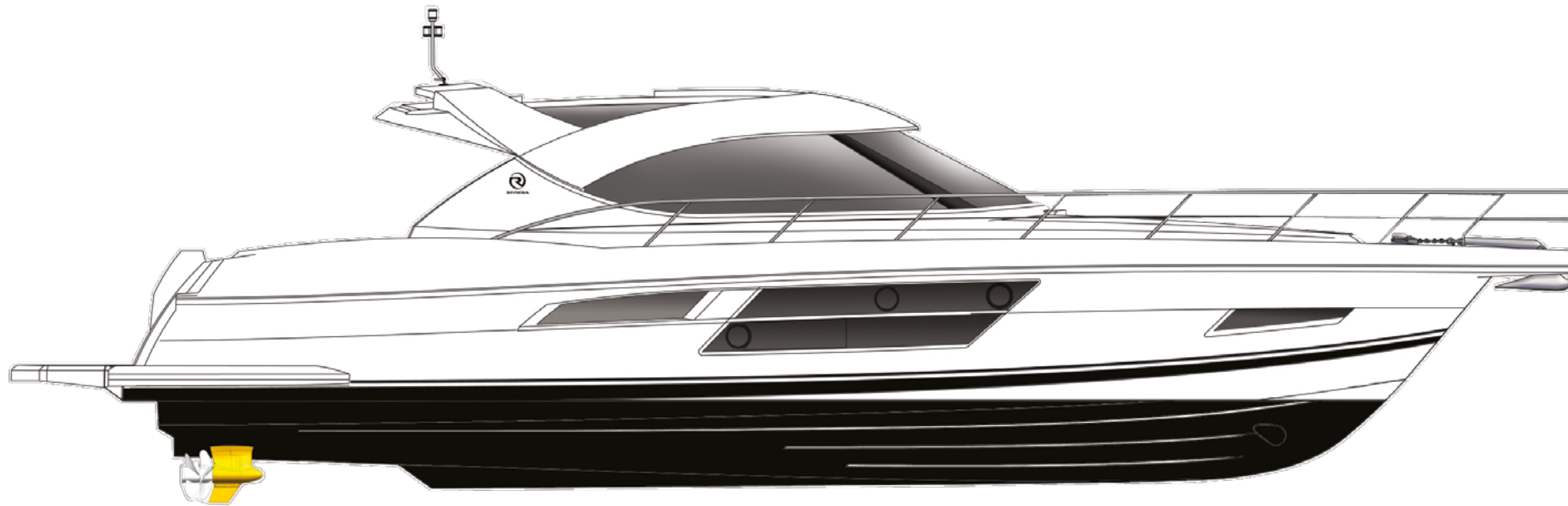

## 5000 Sport Yacht

### SPECIFICATIONS

Length Overall (inc. swim platform and bow sprit)	16.69 m	54' 9"
Lh to ISO8666 *	15.46 m	50' 9"
Beam (inc. gunwale)	4.76 m	15' 7"
Maximum Draft (inc. props)	1.20 m	3' 11"
Dry Weight ** (approx.)	17,820 kg	39,300 lb
Fuel Capacity ***	2,300 L	608 US gal
Water Capacity	750 L	198 US gal
Holding Tank Capacity	151 L	40 US gal
Sleeping Capacity	6 persons	
Cockpit Area	7.90 m <sup>2</sup>	85 ft <sup>2</sup>
Bridge Clearance	3.40 m	11' 2"
Standard Engine		
Cummins QSC 600	442 kW	600 hp each
Zeus® POD Drive x 2		

#### Riviera Clarification of Specification

\*Length of the hull (Lh) to ISO8666: Includes all structural and integral parts (ie. the moulded length of the hull). It excludes parts that can be removed in a non-destructive manner without affecting the structural integrity of the craft, eg. pulpits, outdrives, driving platforms, rubbing strakes.

\*\*Dry weight represents the estimated minimum weight of a boat with standard engines and options, no fuel or water on board, no equipment or provisions and no personnel. The stated dry weight may be exceeded.

\*\*\*Denotes net tank capacity. For useable capacity do not rely on more than 90% of tank capacity. Actual capacity will vary according to boat trim and sea state.

Speeds are subject to normal weather conditions, fuel and/or water levels, passengers and equipment loads.

Refer to your Riviera Owner's Manual and your Dealer for height to hardtop and maximum height details.

The specifications in this document are not complete or definitive and are subject to change without notice and therefore may not be current. Riviera will not be liable (in contract, tort or otherwise) for any loss resulting from the inaccuracy of any information contained in this document.

Specifications may vary on a regional basis. Some images in this brochure may include non-standard or after-market options.

#### Warnings

Riviera is committed to building the best luxury cruisers, tailored to suit specific countries and their individual compliance laws and regulations. Riviera equipment and build specifications approved for one country may not be compliant with another country's safety and equipment regulations and as such those cruisers may have no recourse to Riviera extensive manufacturer's warranties.

Each country and State has different safety equipment standards.

It is important that you ensure the requirements in your jurisdiction are met prior to the vessel being used.

Our PASSION  
To create the *ultimate*  
boating experience.

